

M ISO Metric coarse threads DIN 13

- Metrisches ISO-Gewinde DIN 13
- ISO MÉTRIQUE DIN13
- ISO Metrico passo grosso DIN 13

► For using multi-purpose and correct thread profiles & long tool life due to special tap geometry. YG-1 company has a patent.

► Für vielfältigen Einsatz, genaue Gewindeprofile und lange Standzeit dank einer besonderen Schneidengeometrie. Von YG-1 patentiert.



Long Shank

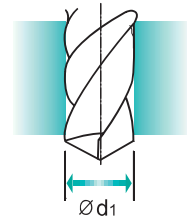
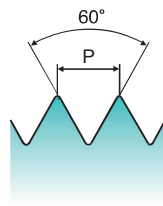
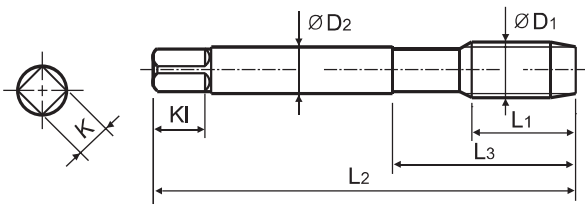

HSS-E
LONG
6H
60°
B
Bright

Machine taps
Maschinengewindebohrer

Recommended Cutting Page : P.117

Unit : mm

SIZE	Pitch	EDP No.	Thread Length	Overall Length	Neck Length	Shank Diameter	Square Size	Square Length	No. of Flute	Tapping Drill Diameter
ØD1	P	Bright	L1	L2	L3	ØD2	K	KI	Z	Ød1
M3 × 0.5		TC445206	11	100	18	3.5	2.7	6	3	2.5
M4 × 0.7		TC445246	13	125	21	4.5	3.4	6	3	3.3
M5 × 0.8		TC445286	15	140	25	6	4.9	8	3	4.2
M6 × 1		TC445316	17	160	30	6	4.9	8	3	5
M8 × 1.25		TC445366	20	180	35	6	4.9	8	3	6.8
M10 × 1.5		TC445426	22	200	39	7	5.5	8	3	8.5
M12 × 1.75		TC445506	24	220	44	9	7	10	3	10.2
M14 × 2		TC445546	26	220	44	11	9	12	3	12
M16 × 2		TC445606	27	220	44	12	9	12	3	14
M20 × 2.5		TC445706	32	280	54	16	12	15	4	17.5

* Coating(TiN, TiCN or TiAlN) or Surface Treatment(Steam Homo) is available on your request.

◎ : Excellent ○ : Good

ISO Material Description	P										M				K								
	Non-alloy steel					Low alloy steel					High alloyed steel, and tool steel				Stainless steel				Grey cast iron		Nodular cast iron		Malleable cast iron
VDI 3323	1	2	3	4	5	6	7	8	9	10	11	12	13	14	15	16	17	18	19	20			
HRC	125	130	190	250	270	180	275	300	350	200	325	200	240	180	180	260	160	250	130	230			
Recommended	○	◎	◎	◎	◎	◎	◎	◎	◎	○	○	◎	◎	◎	◎	◎	◎	◎	◎	◎			

ISO Material Description	N					S										H										
	Aluminum-wrought alloy		Aluminum-cast, alloyed			Copper and Copper Alloys (Bronze / Brass)			Non Metallic Materials		Heat Resistant Super Alloys					Titanium Alloys		Hardened steel	Chilled Cast Iron	Hardened Cast Iron						
VDI 3323	21	22	23	24	25	26	27	28	29	30	31	32	33	34	35	36	37	38	39	40	41					
HRC	60	100	75	90	130	110	90	100			15	30	25	38	34	200	280	250	350	320	400Rm	1050Rm	550	630	400	550
Recommended			◎			◎	◎	◎																		



RECOMMENDED CUTTING CONDITIONS
EMPFOHLENE SCHNEIDKONDITIONEN

HSS

	TDJ06	TBJ06	TCJ07	TDJ07	TBJ07	TCJ08	TDJ08	TBJ08	TC814-IC	TC445	TB428 TB438	TQ428 TQ438
VDI 3323	Vc (m/min)											
1	20-25	15-20	15-20	20-25	15-20	15-20	20-25	15-20	15-20	15-20		
2	20-25	15-20	15-20	20-25	15-20	15-20	20-25	15-20	15-20	15-20	15-20	15-20
3	18-24	12-18	12-18	18-24	12-18	12-18	18-24	12-18	12-18	12-18		
4	15-20	10-15	10-15	15-20	10-15	10-15	15-20	10-15	10-15	10-15	10-15	10-15
5	10-14	6-10	6-10	10-14	6-10	6-10	10-14	6-10	6-10	6-10		
6	15-20	10-15	10-15	15-20	10-15	10-15	15-20	10-15	10-15	10-15	10-15	10-15
7	15-20	10-15	10-15	15-20	10-15	10-15	15-20	10-15	10-15	10-15	10-15	10-15
8	10-14	6-10	6-10	10-14	6-10	6-10	10-14	6-10	6-10	6-10		
9	5-7	3-5	3-5	5-7	3-5	3-5	5-7	3-5	3-5	3-5		
10	5-7	3-5	3-5	5-7	3-5	3-5	5-7	3-5	3-5	3-5		
11												
12	10-15	7-10	7-10	10-15	7-10	7-10	10-15	7-10	7-10	7-10	7-10	7-10
13	8-11	5-8	5-8	8-11	5-8	5-8	8-11	5-8	5-8	5-8	5-8	5-8
14	6-8	4-6	4-6	6-8	4-6	4-6	6-8	4-6	4-6	4-6	4-6	4-6
15	15-20	10-15	10-15	15-20	10-15	10-15	15-20	10-15	10-15	10-15		
16	8-11	5-8	5-8	8-11	5-8	5-8	8-11	5-8	5-8	5-8		
17	15-20	10-15	10-15	15-20	10-15	10-15	15-20	10-15	10-15	10-15		
18	8-11	5-8	5-8	8-11	5-8	5-8	8-11	5-8	5-8	5-8		
19												
20												
21												
22												
23	20-25	15-20	15-20	20-25	15-20	15-20	20-25	15-20	15-20	15-20		
24												
25												
26	35-40	25-35	25-35	35-40	25-35	25-35	35-40	25-35	25-35	25-35		
27	12-17	8-12	8-12	12-17	8-12	8-12	12-17	8-12	8-12	8-12		
28	20-25	15-20	15-20	20-25	15-20	15-20	20-25	15-20	15-20	15-20	15-20	15-20
29												
30												
31												
32												
33												
34												
35												
36												
37												
38												
39												
40												
41												

THREAD MILLS

SYNCHRO TAPS

COMBO TAPS

YG TAP GENERAL

YG TAP STEEL

YG TAP HARDENED

YG TAP INOX

YG TAP CAST IRON

YG TAP ALU

YG TAP Ti Ni

YG TAP FORMING

NUT TAPS

STI TAPS

PIPE TAPS

TECHNICAL DATA